



High Point, Overton Park Road, Cheltenham, Gloucestershire, GL50 3BB

Per Month Rental Price of £795

A very spacious two double bedroom apartment well situated for the town centre, set off Overton Park Road with superb views across Cheltenham.

Perched up on the top floor of High Point, this large apartment is beautifully presented. The property consists of a spacious entrance hall, two large double bedrooms with built in wardrobes and a family shower room. Living accommodation is made up of a large sitting room with an adjoining dining area. A separate fitted kitchen is set off from here where you will find a washer, dryer, fridge and freezer, gas hob, oven and grill.

The property also boasts a balcony that overlooks the surrounding area and beyond, an elevator and a single garage for parking.

Situation: High Point is just a short walk to the centre of town and is within close proximity to the railway station, with Waitrose just across the road.

No pets, smokers or benefits.

Registered Company No. 9423120



Registered Company No. 9423120

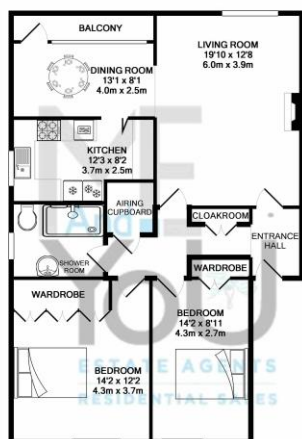

Whilst every attempt has been made to ensure the accuracy of the floor plan contained here, measurements of doors, windows, rooms and any other items are approximate and no responsibility is taken for any error, omission, or mis-statement. This plan is for illustrative purposes only and should be used as such by any prospective purchaser. The services, systems and appliances shown have not been tested and no guarantee as to their operability or efficiency can be given.
Made with Metropix 620177



Registered Company No. 9423120

t: 01242 584007 · e: info@meandyouestateagents.co.uk · 21 Rodney Road, Cheltenham, GL50 1HX

www.meandyouestateagents.co.uk



Registered Company No. 9423120



Registered Company No. 9423120



Registered Company No. 9423120



Registered Company No. 9423120