



5 Hazledean Road  
Cheltenham

**ME**  
And **YOU**  
ESTATE AGENTS  
SALES & LETTINGS











A beautifully presented two double bedroom mid terraced house situated in a quite cul-de-sac on the outskirts of Cheltenham, with off road parking for two vehicles and a low maintenance garden to the rear.

This property is comprised of a good sized kitchen which overlooks the front and a spacious living room with space for dining set to the rear. The living room is very well presented with neutral colours and floors laid with good quality laminate wood. The rear garden presents a nice space to sit and relax and is laid with grass with a decked area too.

The First floor is occupied by a large master bedroom with a built in wardrobe and a alcove that is ideal for extra furniture, and a good sized second bedroom which is suitable as a double. Both rooms are served by a well presented family bathroom that has an electric shower set over the bath.

The property benefits with gas central heating, double glazed windows and doors, parking for two vehicles and is suitably presented so there would be little to do for its next owners. A perfect house for first time buyers or landlord investors.

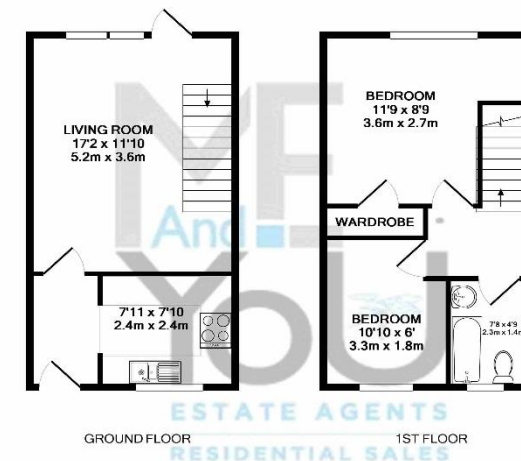

Whilst every attempt has been made to ensure the accuracy of the floor plan contained here, measurements of doors, windows, rooms and any other items are approximate and no responsibility is taken for any error, omission, or mis-statement. This plan is for illustrative purposes only and should be used as such by any prospective purchaser. The services, systems and appliances shown have not been tested and no guarantee as to their operability or efficiency can be given.  
Made with Motopix ©2018