



Hollis Road
Cheltenham

ME
And
YOU
ESTATE AGENTS
SALES & LETTINGS







ME And You are delighted to present for sale this four bedroom family home situated in Up Hatherley. This well laid out property provides ample space inside and out whilst continuing to offer room for expansion if desired.

The ground floor is comprised of a spacious entrance hallway with rooms set off. The bay fronted living room overlooks the front and boasts a neatly built in wood burner, whilst to the rear a spacious dining room looks out to the impeccable garden. The kitchen is well presented and modern expanding out to the rear where you will find space for breakfasting or to simply relax with the French doors opening to the garden.

The rear garden is beautifully landscaped and provides a large patio, lawn, a single garage, store shed, and a BBQ corner to the rear. A handy wood store is also situated here for the wood burner.

The first floor is occupied by a large bay fronted master bedroom, two double bedrooms and one good size single. These rooms are all serviced by a family bathroom.

Parking to the front of the property is ample, enough for several vehicles.

This property is presented beautifully and is a perfect family home in a very well regarded residential location. It sits close to a number of local schools ranging from play groups through to secondary. Local amenities are plentiful and access to the M5 motorway is just a couple of minutes away.

Viewing by pre-arranged appointment only. Please contact 01242 584 007.

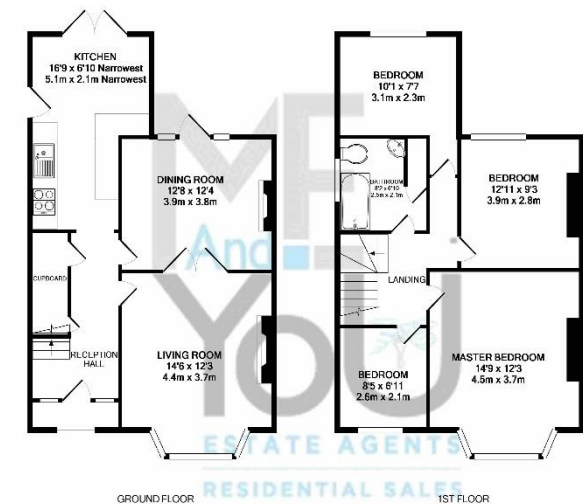

While every attempt has been made to ensure the accuracy of the floor plan contained here, measurements of doors, windows, rooms and any other items are approximate and no responsibility is taken for any error, omission, or misstatement. This plan is for illustrative purposes only and should be used as such by any prospective purchaser. The accuracy of the floor plan is not guaranteed and no guarantee is given as to the accuracy of the floor plan. The accuracy of the floor plan is not guaranteed and no guarantee is given as to the accuracy of the floor plan. Made with Metaphor 02/21