



## **Lawnswood Court, Wellington Square, Cheltenham Gloucestershire, GL50 4AB**

**£550,000 Asking Price**

We are delighted to offer for sale this penthouse apartment which is set atop Lawnswood Court, an elegant collection of apartments nestled within a quiet corner of Wellington Square, one of the most sought after and attractive locations to live within Cheltenham Town.

Spread out over approximately 1600 sq ft and boasting spectacular views from all aspects, this property is spacious, modern and perfectly situated. Wellington square is an impressive location with central gardens lined with Regency and Victorian property's. This property benefits with undercroft parking with elevator access from this level to the penthouse. Offering an open plan layout, the living and dining area stretches the length of the apartment and flows through to a spacious, modern and fully equipped kitchen adjacent. The kitchen is of a high standard boasting solid wooden worktops, tiled flooring, a NEFF induction hob with Bosch oven beneath, washer/dryer and dish washer all provided and built in.

Solid oak wooden flooring extends from the living space through to the hallway where you will find the three bedrooms, two of which are large doubles and one a well proportioned single. The master bedroom boasts an en-suite shower room with a double walk in shower, whilst the family bathroom is of great proportions, furnished with a large freestanding luxury bath.

Dormer windows bath each room in light and offer superb platforms from which to view the surrounding town and countryside. You will find that Pittville park is moments away and the town centre just a short walk. Furthermore, the highly regarded Dunalley Primary School is set just next door to Lawnswood Court.

A superb, beautifully presented property where viewing comes highly recommended.

Information regarding annual service charges to be considered. Please enquire for further information.

Registered Company No. 9423120

## Front Of Property



Registered Company No. 9423120

---

t: 01242 584007 · e: [info@meandyouestateagents.co.uk](mailto:info@meandyouestateagents.co.uk) · 21 Rodney Road, Cheltenham, GL50 1HX

[www.meandyouestateagents.co.uk](http://www.meandyouestateagents.co.uk)

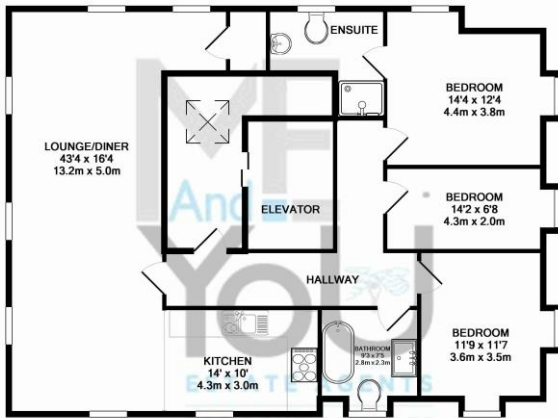

Whilst every attempt has been made to ensure the accuracy of the floor plan contained here, measurements of doors, windows, rooms and any other items are approximate and no responsibility is taken for any error, omission, or mis-statement. This plan is for illustrative purposes only and should be used as such by any prospective purchaser. The services, systems and appliances shown have not been tested and no guarantee as to their operability or efficiency can be given.  
Made with Metropix ©2016







Registered Company No. 9423120









Registered Company No. 9423120





Registered Company No. 9423120



