



HEARNES

WHERE SERVICE COUNTS

**Colehill
Dorset, BH21 2JT**

Colehill, Dorset, BH21 2JT

FREEHOLD PRICE: £375,000

A well proportioned, extended two/three bedroom semi-detached bungalow set on a generous size, sunny plot with a stocked mature garden and parking for several cars.

- Good size entrance hall with loft access
- Kitchen with a range of wood effect units and complementary worktops, tiled floor, free-standing washing machine and electric cooker, space for fridge freezer
- Dual aspect sitting room with wood burning stove and rear aspect to garden and side access
- Dining room/study
- Two large double bedrooms, one with garden views
- Family bathroom with bath, separate shower cubicle, pedestal wash hand basin, WC and heated towel rail
- Outside: Well stocked garden with two French pear trees, plum and apple trees, herb garden, patio and lawn
- Driveway with off road parking

Dales Drive is a popular location and is approximately two miles from Wimborne town centre where there are a number of shops, restaurants, public houses and the popular Tivoli Theatre.

COUNCIL TAX BAND: C EPC RATING: D

AGENTS NOTES: The heating system, mains and appliances have not been tested by Hearnes Estate Agents. Any areas, measurements or distances are approximate. The text, photographs and plans are for guidance only and are not necessarily comprehensive. Whilst reasonable endeavours have been made to ensure that the information in our sales particulars are as accurate as possible, this information has been provided for us by the seller and is not guaranteed. Any intending buyer should not rely on the information we have supplied and should satisfy themselves by inspection, searches, enquiries and survey as to the correctness of each statement before making a financial or legal commitment. We have not checked the legal documentation to verify the legal status, including the leased term and ground rent and escalation of ground rent of the property (where applicable). A buyer must not rely upon the information provided until it has been verified by their own solicitors.



Ground Floor

Approx. 76.6 sq. metres (824.8 sq. feet)

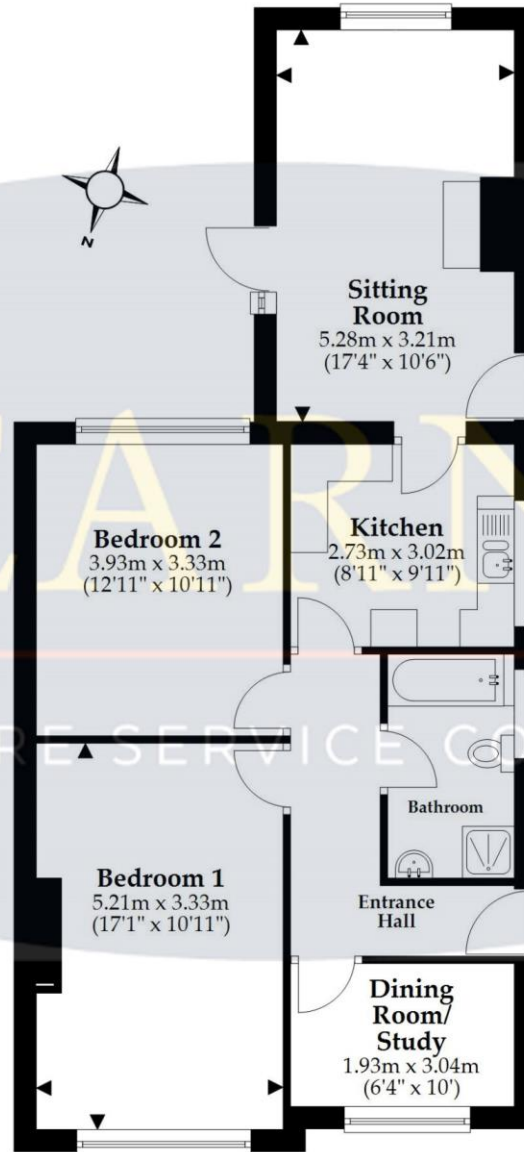

Total area: approx. 76.6 sq. metres (824.8 sq. feet)

This plan is not to scale and is for general guidance only. LJT Surveying Ltd Ringwood



6 Cook Row, Wimborne, Dorset BH21 1LB Tel: 01202 842922 Email: wimborne@hearnes.com www.hearnes.com

OFFICES ALSO AT: BOURNEMOUTH, FERNDOWN, POOLE & RINGWOOD

