



HEARNES

WHERE SERVICE COUNTS

Corfe Mullen
Dorset, BH21 3HW

FOR SALE

Corfe Mullen, Dorset, BH21 3HW

FREEHOLD PRICE: £515,000

An outstanding and immaculately presented four bedroom family home beautifully positioned in a semi-rural setting enjoying stunning open-field views to the rear. This exceptional property offers spacious and stylish accommodation throughout, featuring a superb main bedroom with an elegant en suite, a stunning open plan sitting, dining and kitchen area designed perfectly for modern family living and entertaining. A state-of-the-art garden room further enhances the versatile living space.

Externally the home benefits from ample off-road parking and a beautifully landscaped rear garden backing directly onto open field creating a peaceful and private outdoor retreat.

- Entrance porch leading to entrance hallway
- Modern fitted kitchen with range of base and eye level units with complementary wooden worktops, matching central island and breakfast bar, space for appliances, built in pantry and square arch to sitting/dining area
- Stunning sitting/dining room with feature corner wood burner and herringbone style flooring running through to the kitchen and cloakroom with triple track sliding door leading onto the garden
- Four good size bedrooms: main bedroom with range of bedroom furniture and luxury en suite shower room
- Family bathroom with three-piece suite
- Double glazing and gas heating
- Outside: ample off road parking leading to garage. The rear garden must be viewed to fully appreciate. Decking area to the rear leading onto shaped lawn with an abundance of colourful raised flower beds and shingle pathway leading to a modern built garden room/office/gymnasium with superb outlook over garden with bi-fold windows, solar panels and adjacent shed, an outside warm water tap for pets and external mood lighting. To the rear, a further patio terrace area, ideal for al fresco dining with view over open field

The property is situated in a well established area which is renowned for its sought after schools and in close proximity to the local shops and amenities of Corfe Mullen.

EPC RATING: C COUNCIL TAX BAND: D

AGENTS NOTES: The heating system, mains and appliances have not been tested by Hearn's Estate Agents. Any areas, measurements or distances are approximate. The text, photographs and plans are for guidance only and are not necessarily comprehensive. Whilst reasonable endeavours have been made to ensure that the information in our sales particulars are as accurate as possible, this information has been provided for us by the seller and is not guaranteed. Any intending buyer should not rely on the information we have supplied and should satisfy themselves by inspection, searches, enquiries and survey as to the correctness of each statement before making a financial or legal commitment. We have not checked the legal documentation to verify the legal status, including the leased term and ground rent and escalation of ground rent of the property (where applicable). A buyer must not rely upon the information provided until it has been verified by their own solicitors.





Note: Measurements were not taken by LJT Surveying and we can not guarantee their accuracy.

Ground Floor

Approx. 57.6 sq. metres (620.5 sq. feet)

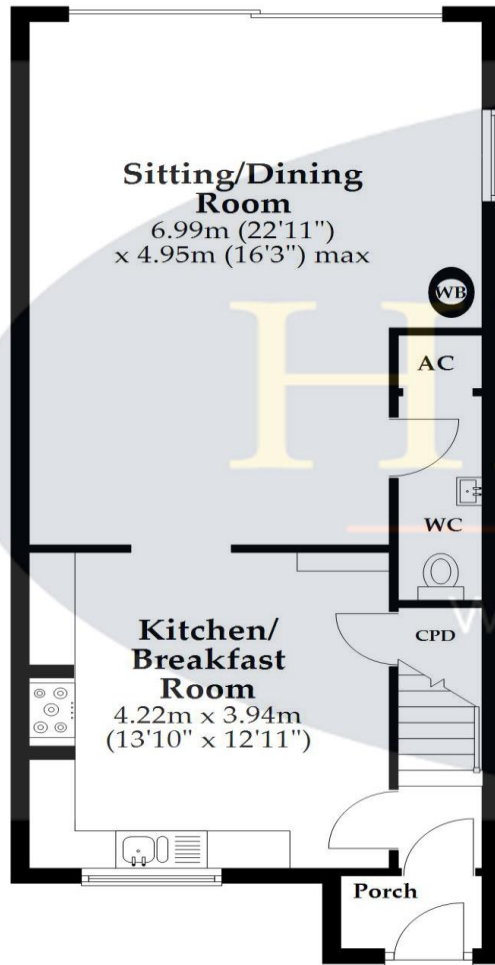

First Floor

Approx. 56.0 sq. metres (602.9 sq. feet)



Outbuildings

Approx. 29.9 sq. metres (321.6 sq. feet)

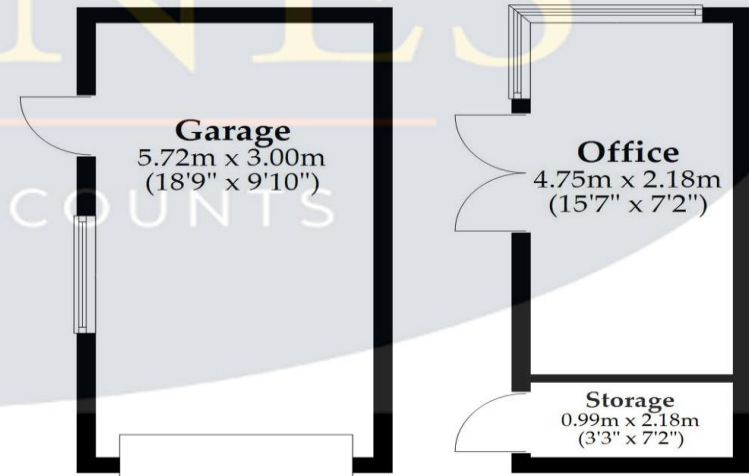

Main area: Approx. 113.7 sq. metres (1223.4 sq. feet)

Plus outbuildings, approx. 29.9 sq. metres (321.6 sq. feet)

This plan is not to scale and is for general guidance only. LJT Surveying Ltd Ringwood





www.hearnes.com

6 Cook Row, Wimborne, Dorset BH21 1LB

Tel: 01202 842922 Email: Wimborne@hearnes.com

OFFICES ALSO AT: BOURNEMOUTH, FERNDOWN, POOLE & RINGWOOD