



HEARNES

WHERE SERVICE COUNTS

Bickerley, Ringwood, Hampshire, BH24 1EQ

LEASEHOLD

A well-presented two double bedroom ground floor apartment situated in this most popular development within walking distance of the town centre, situated just off the Bickerley with delightful communal gardens and views over the River Avon. The property also benefits from a single garage and additional parking space.

On entering the property there is a large hallway offering access to all rooms and storage cupboards. The kitchen/breakfast room has views out to the side and comprises of base and wall mounted units, space for an oven, washing machine or dishwasher and a fridge freezer. The lounge is of a good size with views out to the communal gardens towards the river.

There are two double bedrooms with the master benefitting from built in wardrobes and views out to the front and bedroom two benefitting from views out to the rear. Both bedrooms are serviced by the bathroom which has a fitted with a white suite consisting of a panelled bath with shower attachment over, pedestal wash hand basin and WC.

Outside there are well cared for communal gardens with views over the river and the apartment benefits from a garage and additional parking space.

Viewing highly recommended to truly appreciate the sought after location of this fabulous apartment.

Situation: Ringwood offers a weekly street market, in addition to comprehensive range of shopping, leisure and educational facilities. The A.31 and A.338 provide transportation links to Bournemouth (12 miles), Southampton (16 miles) and Salisbury (18 miles). The open New Forest is within two miles distance.

AGENTS NOTE: We are advised that the Lease is in the process of being extended at the cost of the owners.

COUNCIL TAX BAND: C

ENERGY PERFORMANCE RATING: D

AGENTS NOTE: The heating system, mains and appliances have not been tested by Hearn's Estate Agents. Any areas, measurements or distances are approximate. The text, photographs and plans are for guidance only and are not necessarily comprehensive and do not form part of the contract.



Ground Floor

Approx. 59.1 sq. metres (636.7 sq. feet)

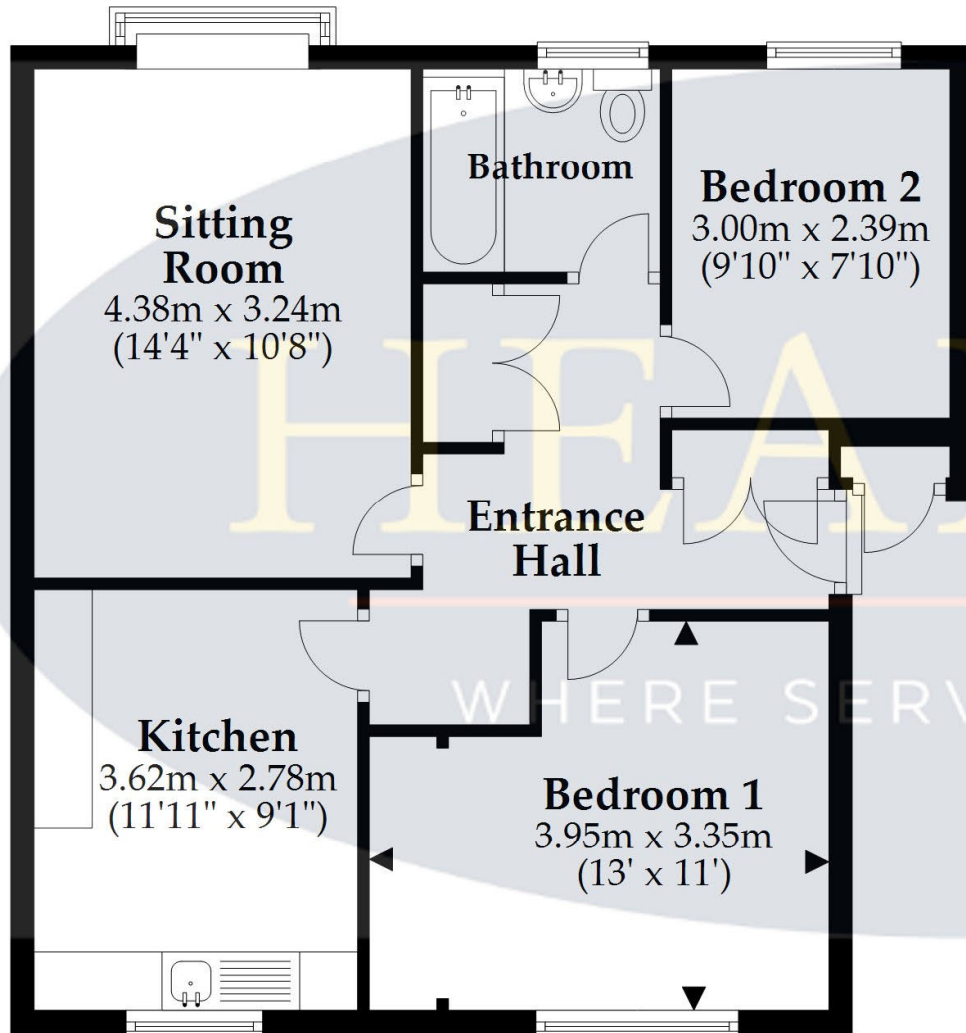

Outbuilding

Approx. 12.2 sq. metres (131.0 sq. feet)

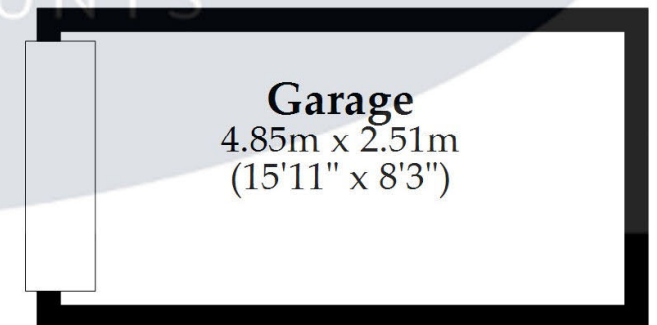

Total area: approx. 71.3 sq. metres (767.7 sq. feet)

This plan is not to scale and it is for general guidance only. LJT Surveying Ringwood

52-54 High Street, Ringwood, Hampshire, BH24 1AG Tel: 01425 489955 Email: ringwood@hearnes.com www.hearnes.com

OFFICES ALSO AT: BOURNEMOUTH, FERNDOWN, POOLE & WIMBORNE

