



Wimborne
Dorset, BH21 2BE

Wimborne, Dorset, BH21 2BE

FREEHOLD PRICE £290,000

A well-presented and spacious three bedroom end of terrace home with south facing rear garden situated in a cul de sac location within approximately half a mile of the town centre.

- Spacious entrance porch
- Entrance hallway with cloaks cupboard and under stairs storage
- Modern downstairs cloakroom with WC and vanity unit
- Feature tiled flooring in hallway/cloakroom/kitchen
- Generous sitting room leading through to dining room
- Galleried kitchen with white gloss units, inset gas hob and electric oven with space for appliances
- Three good size bedrooms
- Master bedroom with built in wardrobes
- Stunning contemporary bathroom with white three piece suite and overhead fitted rainfall shower
- Double glazing and gas heating, Valiant boiler with guarantee
- Off road parking for two cars leading to integral garage
- Private enclosed garden with lawn and patio enjoying a southerly aspect

The location of the property combines the advantage of town with easy access to open countryside and the river Stour nearby. Wimborne town centre is within walking distance where there are a number of shops, restaurants, public houses and the popular Tivoli theatre.

EPC RATING: D

AGENTS NOTE: The heating system, mains and appliances have not been tested by Hearnese Estate Agents. Any areas, measurements or distances are approximate. The text, photographs and plans are for guidance only and are not necessarily comprehensive.



Note: Measurements were not taken by LJT Surveying and we cannot guarantee their accuracy.

Ground Floor

Approx. 64.4 sq. metres (693.2 sq. feet)

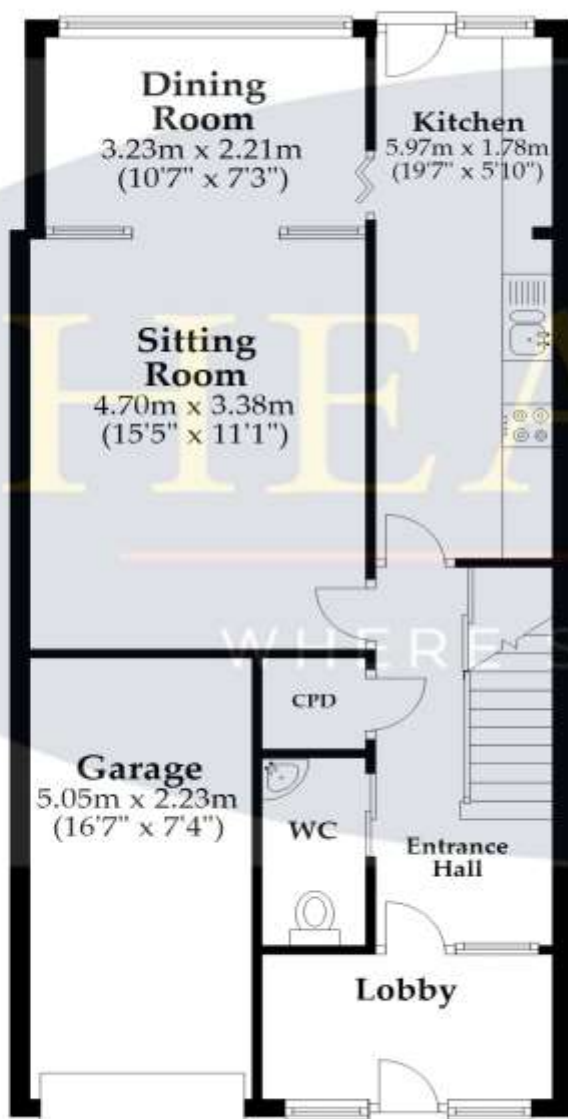

First Floor

Approx. 41.1 sq. metres (442.0 sq. feet)

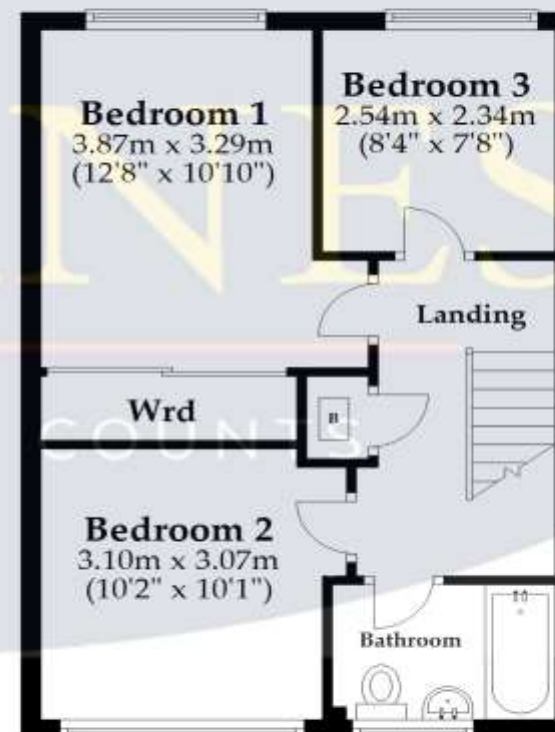

Total area: approx. 105.5 sq. metres (1135.2 sq. feet)

This plan is not to scale and it is for general guidance only. LJT Surveying Ringwood



6 Cook Row, Wimborne, Dorset BH21 1LB Tel: 01202 842922 Email: wimborne@hearnes.com www.hearnes.com

OFFICES ALSO AT: BOURNEMOUTH, FERNDOWN, POOLE & RINGWOOD

