



Queens Close, West Moors
Dorset, BH22 0HW

FREEHOLD PRICE

£375,000

“A well-proportioned and conveniently located bungalow with a double garage and no chain”

This generous sized and superbly positioned three double bedroom, one bathroom, one en-suite detached bungalow has a 23ft conservatory, south facing garden, detached double garage and generous off-road parking. Situated in a peaceful yet convenient location approximately 200 metres from the village centre of West Moors. Offered with no onward chain.

- 23ft Entrance hall
- 14ft **Sitting room**
- 23ft **Conservatory** with a radiator allowing for this room to be used all year round
- **Kitchen** with integrated five ring gas hob with extractor canopy above, Bosch double oven, recess for all appliances, wall-mounted gas-fired boiler and a door leading out to the side driveway
- **Three double bedrooms**
- **En-suite shower room** finished in a modern white suite
- **Family bathroom** finished in a stylish white suite to incorporate a corner bath with shower over, pedestal wash hand basin and WC
- **South facing rear garden** measuring approximately 30ft in width and offering a good degree of privacy. The garden incorporates a lawned area, patio area and a raised vegetable garden with fruit cages
- Side gate opening onto the side driveway
- Double wooden gates give access to a **side driveway** providing generous off-road parking for several vehicles
- Detached **double garage** with light, power, window, side door and a remote control up and over door
- Useful 10ft x 8ft timber storage shed to the side of the garage
- Further benefits include double glazing and a gas-fired central heating system

West Moors offers a good selection of day to day amenities. Ferndown's town centre is located less than 2 miles away and offers a further selection of shopping, leisure and recreational facilities.

COUNCIL TAX BAND: D

EPC RATING: D

AGENTS NOTE: The heating system, mains and appliances have not been tested by Hearnese Estate Agents. Any areas, measurements or distances are approximate. The text, photographs and plans are for guidance only and are not necessarily comprehensive.

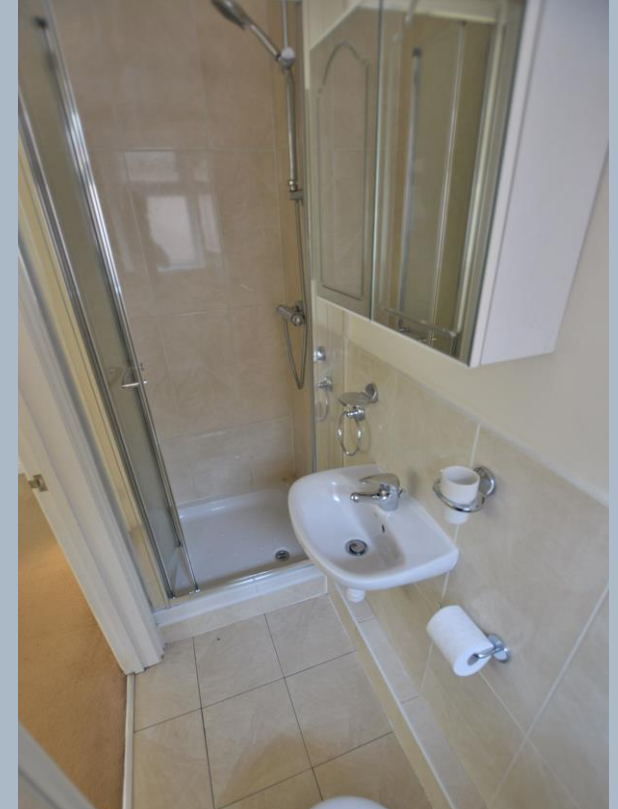

Ground Floor

Approx. 137.1 sq. metres (1475.5 sq. feet)

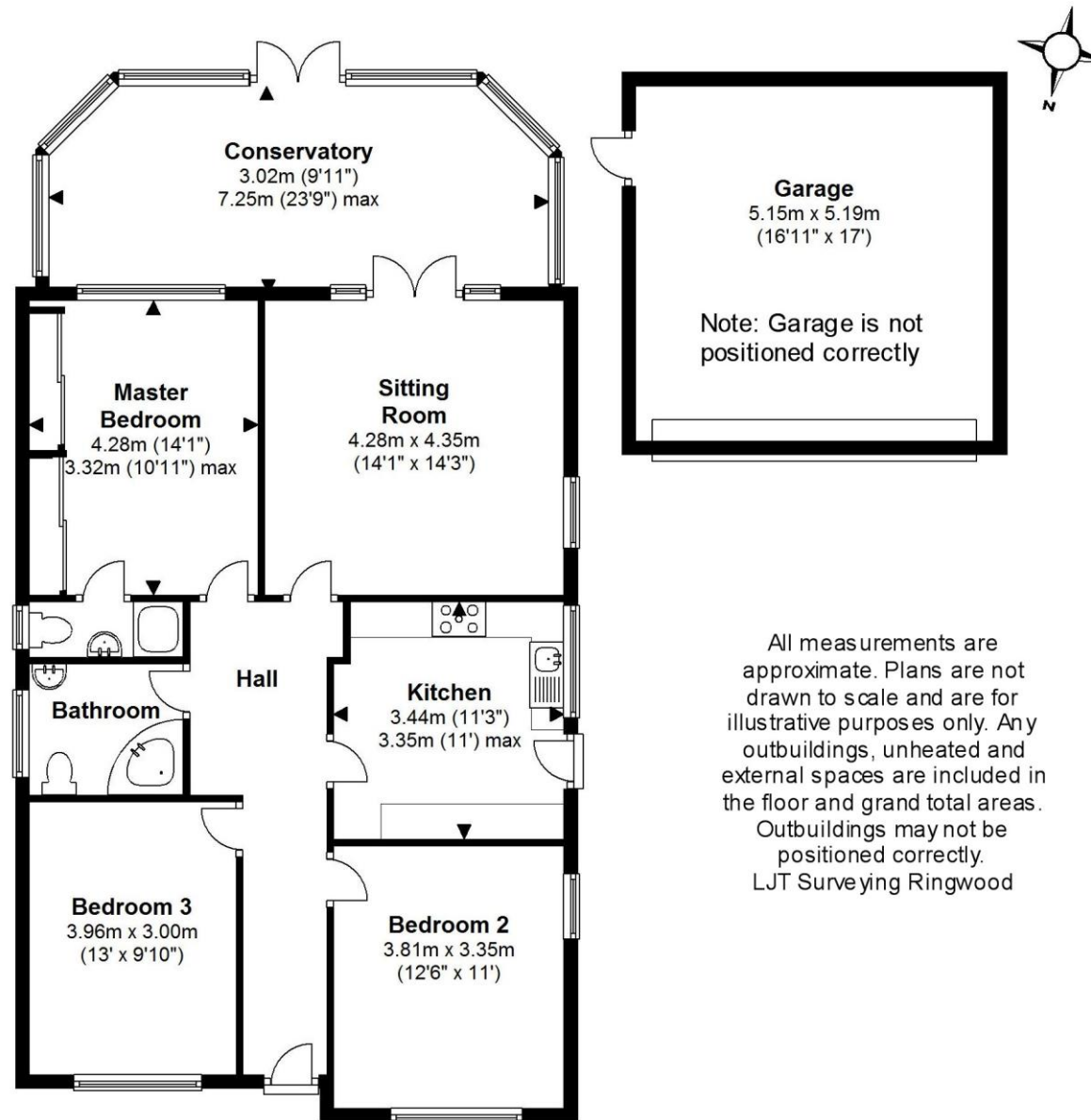

Total area: approx. 137.1 sq. metres (1475.5 sq. feet)

390 Ringwood Road, Ferndown, Dorset. BH22 9AU Tel: 01202 890890 Email: ferndown@hearnes.com www.hearnes.com

OFFICES ALSO AT: BOURNEMOUTH, POOLE, RINGWOOD & WIMBORNE

